

# MSS-SP114 HEAVY PATTERN STAINLESS STEEL FITTINGS ELBOWS - 90° STREET

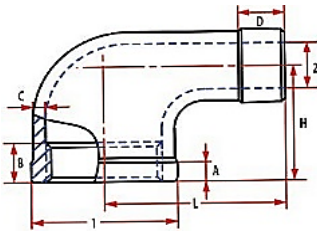
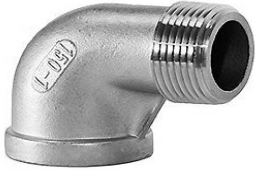

304 SS	316 SS	Size	Weight (LBS)	A	B	C	D	H	L	1	2
SS304-60201	SS316-60201	1/8"	0.06	0.20	0.27	0.11	0.3	0.76	0.97	0.72	0.19
SS304-60202	SS316-60202	1/4"	0.08	0.20	0.33	0.114	0.46	0.78	1.08	0.81	0.25
SS304-60203	SS316-60203	3/8"	0.12	0.20	0.36	0.081	0.48	0.84	1.34	0.96	0.34
SS304-60204	SS316-60204	1/2"	0.19	0.24	0.42	0.081	0.63	1.00	1.51	1.15	0.49
SS304-60206	SS316-60206	3/4"	0.32	0.26	0.49	0.098	0.65	1.20	1.75	1.4	0.62
SS304-60210	SS316-6021C	1"	0.46	0.29	0.57	0.106	0.78	1.37	1.95	1.7	0.87
SS304-60212	SS316-60212	1 1/4"	0.78	0.33	0.65	0.12	0.8	1.6	2.32	2.05	1.13
SS304-60214	SS316-60214	1 1/2"	1.03	0.36	0.68	0.121	0.83	1.76	2.55	2.33	1.32
SS304-60220	SS316-60220	2"	1.69	0.4	0.73	0.141	0.88	2.07	3.02	2.82	1.74
SS304-60224	SS316-60224	2 1/2"	2.73	0.46	0.89	0.175	1.3	2.49	3.61	3.15	2.13
SS304-60230	SS316-61230	3"	4.23	0.53	0.95	0.2	1.4	2.82	4.19	3.83	2.68
SS304-60240	SS316-60240	4"	7.98	0.63	1.04	0.216	1.49	3.52	5.34	4.83	3.61

## MSS-SP114 HEAVY PATTERN STAINLESS STEEL FITTINGS

Stainless steel MSS-SP114 heavy pattern fittings are investment castings.  
Available in a full range from 1/8" to 4" in both 304 and 316 grades of stainless steel.  
All fittings are threaded to NPT standard in compliance to ASME B1.20.  
Castings are made in accordance to ASTM 351 and heat treated and tested in accordance to ASTM A262

OEMS AND MANUFACTURERS TRUST BFO TO KEEP YOUR OPERATION FLOWING SMOOTHLY

[BUYFITTINGSONLINE.COM](http://BUYFITTINGSONLINE.COM) | [1.800.569.0810](tel:1.800.569.0810) | [BFO@QMCTECHNOLOGIES.COM](mailto:BFO@QMCTECHNOLOGIES.COM)