

Pipe Fittings - Lead Free Brass 125#

- Approved to ANSI/NSF 61-4 California AB 1953
- Meets Federal State Drinking Water Act
- Lead Free Requirement: Brass pipe fittings conform to AWWA C800
- Brass castings conform to ASTM B584, UNS Alloy C89833
- Brass pipe fittings dimensions conform to ASME B16.15
- NPT threads on all pipe fittings conform to ASME B1.20.1
- Brass unions conform to specification A-A-59617

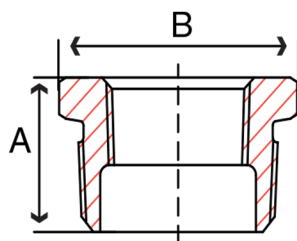

Hex Bushings - 125# Pipe Fittings - Lead Free

Size in	Part Number	A in	B in	Hex	Packing		Weight lb
					Inner	Master	
1/4 x 1/8		0.61	0.66	Out	120	1920	0.05
3/8 x 1/8		0.81	0.73	Out	75	1200	0.05
3/8 x 1/4		0.81	0.73	Out	75	1200	0.05
1/2 x 1/8	B9-CA	0.95	0.88	Out	100	800	0.1
1/2 x 1/4	B9-CB	0.81	0.90	Out	100	800	0.09
1/2 x 3/8	B9-C	0.81	0.90	Out	100	800	0.07
3/4 x 1/8	B9-DA	0.88	1.18	Out	50	600	0.1
3/4 x 1/4	B9-DB	0.93	1.18	Out	40	480	0.1
3/4 x 3/8	B9-DC	0.93	1.18	Out	50	600	0.1
3/4 x 1/2	B9-D	0.93	1.18	Out	40	480	0.1
1 x 1/4	B9-EB	1.13	1.12	In	50	400	0.2
1 x 3/8	B9-EC	1.13	1.12	In	50	400	0.2
1 x 1/2	B9-ED	1.10	1.44	Out	40	320	0.2
1 x 3/4	B9-E	1.10	1.44	Out	40	360	0.2
1-1/4 x 1/2	B9-FD	1.18	1.80	Out	30	120	0.3
1-1/4 x 3/4	B9-FE	1.18	1.80	Out	30	120	0.4
1-1/4 x 1	B9-F	1.18	1.80	Out	30	120	0.3
1-1/2 x 1/2	B9-GD	1.27	1.34	In	25	100	0.4
1-1/2 x 3/4	B9-GE	1.27	1.63	In	25	100	0.4
1-1/2 x 1	B9-GF	1.19	2.04	Out	25	100	0.5
1-1/2 x 1-1/4	B9-G	1.19	2.04	Out	25	100	0.4
2 x 1/2	B9-HD	1.35	1.36	In	20	80	0.6
2 x 3/4	B9-HE	1.35	1.65	In	20	80	0.7
2 x 1	B9-HF	1.35	2.00	In	20	80	0.7
2 x 1-1/4	B9-HG	1.35	2.50	Out	20	80	0.8
2 x 1-1/2	B9-H	1.35	2.55	Out	20	80	0.8
2-1/2 x 1-1/4	B9-IG	1.60	3.15	Out	12	48	1.2
2-1/2 x 1-1/2	B9-IH	1.52	2.70	In	12	48	1.3
2-1/2 x 2	B9-I	1.62	3.15	Out	12	48	1.1
3 x 1	B9-JF	1.60	2.00	In	12	48	1.6
3 x 1-1/2	B9-JH	1.70	2.70	In	12	48	1.8
3 x 2	B9-JI	1.70	3.25	In	6	24	2.3
3 x 2-1/2	B9-J	1.70	3.90	Out	6	24	2.1
4 x 2	B9-KI	1.80	3.30	In	-	20	3.6
4 x 2-1/2	B9-KJ	2.10	4.75	Out	-	20	3.9
4 x 3	B9-K	2.10	4.75	Out	-	20	4.2

BFO can provide a quote for all sizes listed in the table*
All dimensions are for reference only and subject to change