

Class 150 (Standard) 90° Elbow

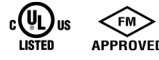

Material Specifications

Dimensions:

Fittings: ASME B16.3
Unions: ASME B16.39
Bushings/Plugs: ASME B16.14

Material: ASTM A-197

Finish: Black or Hot Dip Galvanized per ASTM A153 Class A

Threads*: NPT per ASME B1.20.1

Pressure Ratings:

Fittings: ASME B16.3
Unions: ASME B16.39
Bushings/Plugs: ASME B16.14

Pressure Testing: All malleable iron fittings are tested for through wall porosity using an air under water process.

Agency Approvals: All malleable iron fittings and unions are UL/ULC Listed and FM Approved.

90 DEGREE STREET ELBOWS - 150# MALLEABLE IRON

Nominal Size	Dimension A	Approx Wt. Each
In. (mm)	In. (mm)	Lbs. (kg)
1/8	0.69	0.06
6	17.53	0.03
1/4	0.81	0.10
8	20.57	0.05
3/8	0.95	0.15
10	24.13	0.07
1/2	1.12	0.22
15	28.45	0.10
3/4	1.31	0.36
20	33.27	0.16
1	1.50	0.57
25	38.10	0.26
1 1/4	1.75	0.87
32	44.45	0.40
1 1/2	1.94	1.16
40	49.28	0.53
2	2.25	1.81
50	57.15	0.82
2 1/2	2.70	3.23
65	68.58	1.47
3	3.08	4.82
80	78.23	2.19
4	3.79	8.41
100	96.27	3.82
6	5.13	19.96
150	130.30	9.05

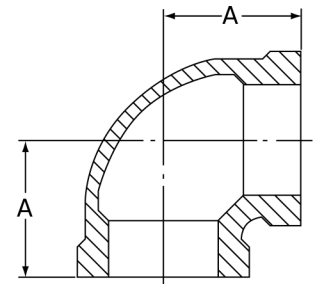

* Dimensions are for reference only and subject to change

KEEP YOUR OPERATION FLOWING SMOOTHLY WITH BFO!

BUYFITTINGSONLINE.COM | 1.800.569.0810 | BFO@QMC TECHNOLOGIES.COM