

# MSS SP-114 HEAVY PATTERN STAINLESS STEEL PIPE FITTINGS UNIONS

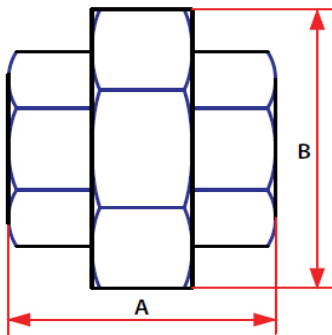

304 SS	316 SS	Size	Weight (LBS)	A	B
BF4381064460	BF4381069160	1/8"	0.17	1.28	1.17
BF4381064480	BF4381069180	1/4"	0.24	1.46	1.31
BF4381064500	BF4381069200	3/8"	0.39	1.63	1.52
BF4381064520	BF4381069220	1/2"	0.45	1.76	1.67
BF4381064540	BF4381069240	3/4"	0.66	1.97	1.99
BF4381064560	BF4381069260	1"	0.91	2.09	2.30
BF4381064580	BF4381069280	1-1/4"	1.27	2.29	2.71
BF4381064600	BF4381069300	1-1/2"	1.68	2.45	3.05
BF4381064620	BF4381069320	2"	2.36	2.76	3.58
BF4381064640	BF4381069340	2-1/2"	4.37	3.23	4.33
BF4381064660	BF4381069360	3"	5.59	3.52	4.98
BF4381064680	BF4381069380	4"	8.96	3.95	6.22

## MSS SP-114 HEAVY PATTERN STAINLESS STEEL PIPE FITTINGS

Stainless steel MSS-SP114 heavy pattern fittings are investment castings.  
Available in a full range from 1/8" to 4" in both 304 and 316 grades of stainless steel.  
All fittings are threaded to NPT standard in compliance to ASME B1.20.  
Castings are made in accordance to ASTM 351 and heat treated and tested in accordance to ASTM A262

OEMS AND MANUFACTURERS TRUST BFO TO KEEP YOUR OPERATION FLOWING SMOOTHLY

[BUYFITTINGSONLINE.COM](http://BUYFITTINGSONLINE.COM) | 1.800.569.0810 | [BFO@QMCTECHNOLOGIES.COM](mailto:BFO@QMCTECHNOLOGIES.COM)